

XCN7 extreme

ENT Nebulizer unit stand type



Color type : ■ Blue ■ Silver

Specifications

Power source	AC 220V, 50/60Hz
Power consumption	200VA
Air compressor	2.0±0.3Kgf/cm ²
Dimension	700mm(W) x 440mm(D) x 833mm(H)
Weight	53Kg

Standard set

Main body	1	Atomizer kit
Atomizer kit	3	Atomizer kit mouthpiece
Atomizer kit mask	3	Atomizer kit mask
Air hose	3	Air hose
Main cable	1	



XCR7 extreme

ENT Treatment Irrigator unit stand type



Color type : ■ Yellow ■ Silver

Specifications

Power source	AC 220V, 50/60Hz
Power consumption	210VA
Use time	1min-10max
Dimension	700mm(W) x 440mm(D) 833mm(H)
Weight	53Kg

Standard set

Main body	1	Rinowash kit
Rinowash kit	3	Rinowash kit cover set
Rinowash kit cover	20	Air hose
Air hose	3	Saline bottle
Saline bottle	1	

Options



ENT Inhalation unit (Extreme series)

XCI7 extreme

ENT Sinus Irrigator stand type

Specifications

Power source	AC 220V, 50/60Hz
Power consumption	1800VA
Dimension	700mm(W) x 493mm(D) x 833mm(H)±10%
Weight	50Kg±10%

Standard set

Standard set	Options
Main body	1 Silicon tip
Foot switch	1 Rinowash kit
Silicon tip	20
Gun set	1
Rinowash kit	1



Color type : ■ Green ■ Silver

Workstation

Patient chair

Endoscopic system

Microscope

Inhalation unit

Inspection equipment

extreme 7 serie



ENT Inhalation unit (Extreme series)

XCN5 extreme

Specifications

Power source	AC 220V, 50/60Hz
Power consumption	85VA
Air compressor	Air pressor 2.0±0.3Kgf/cm ²
Dimension	450mm(W) x 130mm(D) x 366mm(H)±10%
Weight	Approx. 10Kg±10%

Standard set

Options

Main body	1	Atomizer kit
Atomizer kit	2	Atomizer kit mask
Atomizer kit mask	2	Atomizer kit mouthpiece
Atomizer kit mouthpiece	2	
Main cable	1	



ENT Nebulizer wall type



Color type : ■ Blue ■ Silver

XCS5 extreme

Specifications

Power source	AC 220V, 50/60Hz
Power consumption	62VA
Infrared filter	2.1mw/cm ² ±20%(1225±10%)
Dimension	450mm(W) x 130mm(D) x 366mm(H)
Weight	Approx. 10Kg±10%

Standard set

Options

Main body	1	Infrared handle
Infrared handle	2	
Main cable	1	



ENT Infrared device wall type



Color type : ■ Yellow ■ Silver

XCM5 extreme

Specifications

Power source	AC 220V, 50/60Hz
Power consumption	30VA
Use time	1minute-10minute
Pressure	High level 1.0kpa ± 20% low level 7.0kpa ±20%
Velocity	Min 100/min, Max 650/min
Dimension	450mm(W) x 130mm(D) x 366mm(H)
Weight	Approx. 8Kg

Standard set

Options

Main body	1	Two head set type
Head set	1	
Main cable	1	



▲ Single type

ENT Tympano massage unit wall type



Color type : ■ Green ■ Silver

Workstation

Patient chair

Endoscopic system

Microscope

Inhalation unit

Inspection equipment

ENDOSCOPE

Endoscope for ENT

Specifications

SCOPE	Model name			
OTOSCOPE	GD-054	0°	4 Ø	50mm
	GD-059	0°	2.7Ø	60mm
	GD-060	0°	2.7Ø	90mm
SINUSCOPE	GD-051	0°	4 Ø	175mm
	GD-052	30°	4 Ø	175mm
	GD-053	70°	4 Ø	175mm
	GD-074	0°	2.7Ø	175mm
	GD-075	30°	2.7Ø	175mm
	GD-076	70°	2.7Ø	175mm
	LARYNGOSCOPE	GD-061	70°	8 Ø
	GD-062	90°	8 Ø	160mm
	GD-063	70°	6 Ø	185mm



Workstation

Patient chair

ESS-100/200

Endoscope storage device

Specifications

Power source	AC 220V, 50/60Hz
Power consumption	104W
Heater	1°-50°
Suction Motor	220V, 110V
Dimension	290(W)x190(D)x330.5(H)
Weight	Approx 4.5kg ±10%

Standard Set (ESS-100)		Standard Set (ESS-200)	
Main body	1	Main body	1
Base for stand	1	Base for stand	1
Rigid endoscope holder	4	Rigid endoscope holder	4
CCD Camera hanger	1	CCD Camera hanger	1
		Fiberscope hanger	1

Options

Arm for attach



Endoscopic system

Microscope

CMEI-100

ENT Ear & Nasal Irrigator

Specifications

Power source	AC 220V, 50/60Hz
Power consumption	104W
Time	5~90(SEC)
Temperature	1°~45°
Dimension	160(W)x280(D)x320(H)
Weight	8.5kg

Standard Set	Options
Main body	1 Arm for attach
Storage	1
Base for stand	1
Funnel	1
Irrigator hand gun	1
Ear irrigator tip	1
Nasal irrigator 90° tip	1
Irrigator bottle	1500CC



Inhalation unit

Inspection equipment

CHB-120/150/220

Audiometric booth



Model	Dimension	
CHB-120	OUT:1200x1000x2150(H)	OUT:1000x800x1800(H)
CHB-150	OUT:1500x1200x2150(H)	OUT:1300x1000x1850(H)
CHB-220	OUT:2200x2200x2350(H)	OUT:2000x2000x1950(H)



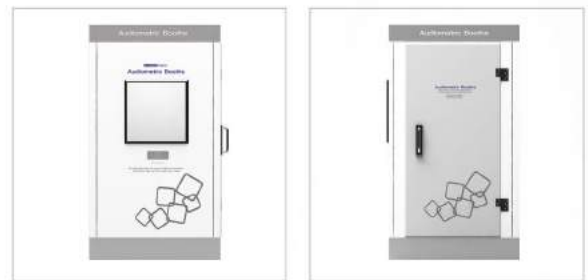

Noise reduction							
Center frequency hz	125	250	500	1000	2000	4000	8000
Single wall room	65	35	40	47	54	59	61

*Custom-Made product are also available



Monitor

Color type : White Black

27" Monitor (HD/Full HD)	19" Monitor (SD)
	
Size : 648.9x400.6x64.3	Size : 413.4x355.4x64.3
24" Monitor (HD/Full HD)	17" Monitor (SD)
	
Size : 563.8x383.4x64.3	Size : 376.4x328.4x62.2